

## DS-7304/7308/7316HFI-ST Standalone DVR

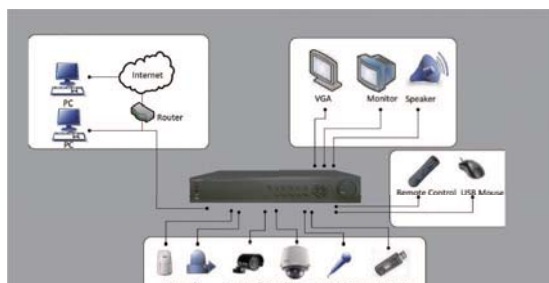

### Key Features

- H.264 video compression
- 4CIF resolution real time recording
- HDMI and VGA output at 1920×1080P resolution
- eSATA interface
- 4/8/16-ch synchronous playback
- SADP(IP Finder), SMTP, SNMP, FTP, NFS, NDP protocols



Rear Panel of DS-7304HFI-ST



- |                                   |   |
|-----------------------------------|---|
| 1. Main video out, Spot video out | 11. USB   |
| 2. Video in                       | 12. RS-485 interface, controller port alarm in, alarm out |
| 3. Audio in                       | 13. GND   |
| 4. LINE in                        | 14. 100~240 VAC power input                               |
| 5. CVBS audio out, VGA audio out  | 15. Power switch  |
| 6. VGA                            |   |
| 7. HDMI                           |   |
| 8. RS-232 interface               |   |
| 9. eSATA                          |   |
| 10. LAN interface                 |   |

### Specifications

|                                      | DS-7304HFI-ST   | DS-7308HFI-ST                                       | DS-7316HFI-ST  |
|--------------------------------------|---|---|--|
| <b>Video / Audio input</b>           |   |   |  |
| Video compression                    | H.264   |   |  |
| Analog video input                   | 4-ch, BNC (1.0 Vp-p,75 Ω), PAL / NTSC self-adaptive   | 8-ch, BNC (1.0 Vp-p,75 Ω), PAL / NTSC self-adaptive | 16-ch, BNC (1.0 Vp-p,75 Ω), PAL / NTSC self-adaptive |
| Audio compression                    | G.711   |   |  |
| Audio input                          | 4-ch, RCA (2.0 Vp-p, 1 kΩ)  |   |  |
| Voice talk input                     | 1-ch, RCA (2.0 Vp-p, 1 kΩ)  |   |  |
| <b>Video / Audio output</b>          |   |   |  |
| HDMI output (with HDMI audio output) | 1-ch, resolution: 1080P:1920×1080 /60 Hz; UXGA: 1600×1200 /60 Hz; SXGA: 1280×1024 /60 Hz; 720P:1280×720 /60 Hz; XGA: 1024×768 /60 Hz.   |   |  |
| VGA output                           | 1-ch, resolution: 1080P:1920×1080 /60 Hz; UXGA: 1600×1200 /60Hz; SXGA: 1280×1024 /60 Hz; 720P:1280×720 /60 Hz; XGA: 1024×768 /60 Hz.  |   |  |
| CVBS output                          | 2-ch (1 Main Video Out+1 Spot Video Out), BNC (1.0 Vp-p, 75 Ω), resolution: PAL: 704×576, NTSC: 704×480   |   |  |
| Video loop out (optional)            | 4-ch  | 8-ch  | 16-ch  |
| Encoding resolution                  | 4CIF / 2CIF / CIF / QCIF  |   |  |
| Frame rate                           | 25 fps (P) / 30 fps (N)   |   |  |
| Video bit rate                       | 32 Kbps ~ 2048 Kbps, or user defined (max. 3072 Kbps)   |   |  |
| Audio output                         | 2-ch, RCA (linear, 600Ω)  |   |  |
| Audio bit rate                       | 64 Kbps   |   |  |
| Dual-stream                          | Support, Sub stream: CIF / QCIF   |   |  |
| Stream type                          | Video, Video & Audio  |   |  |
| Playback resolution                  | 4CIF / 2CIF / CIF / QCIF  |   |  |
| Synchronous playback                 | 4-ch  | 8-ch  | 16-ch  |
| <b>Hard disk</b>                     |   |   |  |
| SATA                                 | 4 SATA interfaces   |   |  |
| eSATA                                | 1 eSATA interface   |   |  |
| Capacity                             | Up to 4TB capacity for each disk  |   |  |
| <b>External interface</b>            |   |   |  |
| Network interface                    | 1 ,RJ45 10M / 100M self-adaptive ethernet interface   |   |  |
| Serial interface                     | 1 RS-232 interface (for parameters configuration, maintenance, transparent channel);<br>1 RS-485 interface (for PTZ control);<br>1 RS-485 keyboard interface (for special keyboard control) |   |  |
| USB interface                        | 3, USB2.0   |   |  |
| Alarm in                             | 8   | 8   | 16   |
| Alarm out                            | 4   |   |  |
| <b>General</b>                       |   |   |  |
| Power supply                         | 100 ~ 240 VAC, 5A, 50~60Hz  |   |  |
| Consumption                          | ≤ 25W (without hard disk or DVD-R/W)  | ≤ 30W (without hard disk or DVD-R/W)                | ≤ 35W (without hard disk or DVD-R/W)                 |
| Working temperature                  | -10 °C ~ + 55 °C  |   |  |
| Working humidity                     | 10% ~ 90%   |   |  |
| Chassis                              | 19-inch rack-mounted 1.5 U chassis  |   |  |
| Dimensions(W x D x H)                | 440 × 390 × 70 mm   |   |  |
| Weight                               | ≤ 8kg (without hard disk or DVD-R/W)  |   |  |