

DS-2CC1191P-A High Definition Box Camera

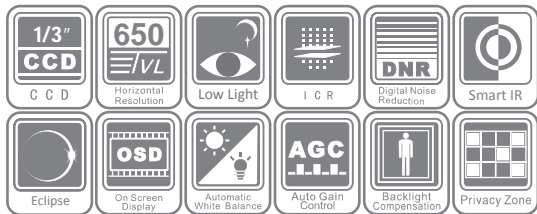

Key Features

- 1/3" Sony EXVIEW HAD CCD II
- 650 TVL high resolution
- Super low illumination
- True day / night
- Smart IR
- Digital wide dynamic range

Dimensions

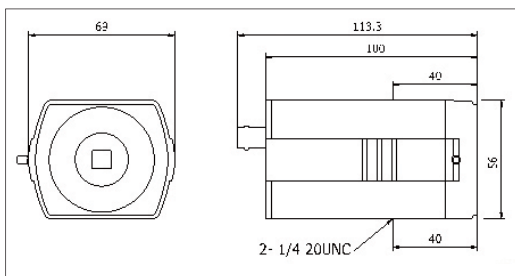

Accessories



Specifications

| DS-2CC1191P-A | |
|-----------------------|------------------------------------------------------------------------------------------------------------------------------------------------------------------|
| Camera | |
| Image sensor | 1/3" Sony EXVIEW HAD CCD II |
| Signal system | PAL |
| Effective pixels | 976 (H) × 582 (V) |
| Min. illumination | Color: 0.001 lux@F1.2, AGC on B/W: 0.0001 lux@F1.2, AGC on |
| Shutter time | 1/50s ~ 1/100,000s |
| Lens mount | C/CS mount |
| Auto iris | DC/Video drive |
| Day & night | IR cut filter with auto switch |
| Horizontal resolution | Color: 650 TVL, B/W: 700 TVL |
| Synchronization | Internal / Power synchronization |
| Video output | 1Vp-p composite output (75 Ω / BNC) |
| S/N ratio | More than 62dB |
| Menu | |
| Camera ID | On / off (16 letters, adjusted position) |
| Auto gain control | Low / middle / high / off |
| D/N mode | Auto1 / auto2 / day / night |
| White balance | Auto trace WB1 / auto trace WB2 / manual / auto Control |
| Private mask | On / off, maximum 8 zones |
| Motion detection | Mode 1 / mode 2 / off |
| BLC | Area / value / off |
| RS-485 | Address / protocol / baud rate |
| Language | English / Chinese |
| Video | SMART IR, digital WDR, excessive highlight compensation, digital noise reduction, sharpness, brightness, saturation, resolution, mirror, defect pixel correction |
| General | |
| Operating conditions | -10°C ~ 60°C (14°F ~ 140°F) Humidity 90% or less (non-condensing) |
| Power supply | 24 VAC ± 10%, 12 VDC ± 10% |
| Power consumption | 5W max. (10W max. with IR cut filter on) |
| Dimensions | 69 x 56 x 113.3 mm (2.72" x 2.20" x 4.46") |
| Weight | 400g (0.88 lbs) |

Available models

DS-2CC1191P-A