

DH-CA-D460P/N

High Resolution Mini Dome Camera



DH-CA-D460P: 540TVL, PAL
DH-CA-D460N: 540TVL, NTSC

Optional Model:

DH-CA-D460P-0280B/DH-CA-D460N-0280B (Lens: 2.8mm)
DH-CA-D460P-0360B/DH-CA-D460N-0360B (Lens: 3.6mm)
DH-CA-D460P-0600B/DH-CA-D460N-0600B (Lens: 6mm)
DH-CA-D460P-0800B/DH-CA-D460N-0800B (Lens: 8mm)

Features

- 1/3" SONY Super HAD II CCD
- High resolution of 540TVL
- Mini. Illumination of 0.1Lux/F1.2
- Auto Electrical Gain control
- Auto Electronic Shutter
- Auto White Balance
- Backlight Compensation
- High Signal to Noise Ratio (SNR)
- Support Pan/Tilt rotation

Dimensions (mm)

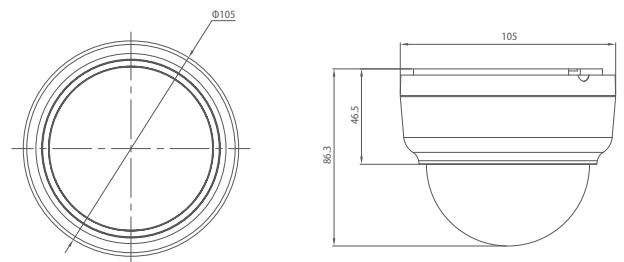

Specifications

Model	DH-CA-D460P	DH-CA-D460N	
Camera	Image Sensor	1/3" SONY Super HAD II CCD	
	Video Format	PAL	NTSC
	Effective Pixels	752(H) x 582(V), 440K pixels	768(H) x 494(V), 380K pixels
	Horizontal Resolution	540TVL	
	Mini. Illumination	Color: 0.1Lux/F1.2	
	Electronic Shutter	1/50s~1/100,000s	1/60s~1/100,000s
	S/N Ratio	>52dB(AGC Off)	
	White Balance	Auto	
	Gain Control	Auto	
	BLC	Auto	
	Synchronization	Internal	
	Video Output	1Vp-p Composite Output (75Ω/BNC)	
Lens	Focal Length	2.8mm, 3.6mm, 6mm, 8mm optionalDC12V±10%	
General	Power Supply	DC12V±10%	
	Power Consumption	2W	
	Working Temperature	-10°C~+60°C	
	Dimension	Φ105mm x 86.3mm	
	Weight	350g	